

PRODUCT DETAILS

All Videofied devices on the system are:	
<u>Wireless</u>	<u>Cordless</u>
<ul style="list-style-type: none"> • Communicate via 900 MHz RF • 2000 feet lab-tested range* • 128-bit AES encryption • GSM cell transmission to central station 	<ul style="list-style-type: none"> • Runs entirely on batteries • No external power required • Up to 4 years battery life

*Surrounding environment affects RF signal. Be sure to test signal beforehand.

Base System Requirements:

1 Panel

1 Arming Device

1 Input Device

Arming Device Note:

CMA 601 keypad required for programming on both V6000 and XL panels.

The CMA 601 must remain part of the V6000 system but can be deleted from XL system after programming.

V6000 PANELS

V6000 GPRS

Base Panel



- Portable
- Durable
- Integrated SIM
- 24 zones
- Can add external GSM cellular antenna and/ or RF antenna

V 6000 ET GPRS

Extended Temperature



- Extended Temperature (-20 –140° F)
- Integrated SIM
- 24 zones
- Can add external GSM cellular antenna and/ or RF antenna

V 6000P GPRS

Xtender

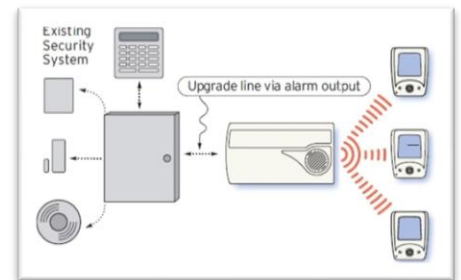

- Piggyback Panel
- Arm through an existing system's programmable output
- Integrated SIM
- 24 zones
- Can add external GSM cellular antenna and/ or RF antenna

XL PANEL & KITS

XL 601

Indoor Panel



- Integrated Keypad
- Prox Card Reader
- Integrated SIM with 2-way voice
- 18 zones

XL 601 Kit includes:

XL Panel, 1 DCV 601, 2 CT 601, 2 prox tags

XL 621

Indoor Panel



- Integrated Keypad
- Prox Card Reader
- Integrated SIM with 2-way voice
- 18 zones

XL 621 Kit includes:

XL Panel, 2 DCV 601, 2 prox tags

XL 631

Indoor Panel



- Integrated Keypad
- Prox Card Reader
- Integrated SIM with 2-way voice
- 18 zones

XL 631 Kit includes:

XL Panel, 1 DCV 651, 2 prox tags

ARMING DEVICES

CMA 601

Alpha Keypad



- Alpha-numeric keypad
- Required for initial programming
- LCD Display
- 3 arming profiles available
- Built-in sounder for status beeps

BR 651

Outdoor Badge Reader



- Prox card reader
- Extended Temperature (-20 –140° F)
- 2 LEDs show system status
- Built-in sounder for status beeps

RC 601

Portable Remote



- 4 buttons for arming and disarming
- Small size for portability
- Set panic without having to be at keypad

INPUT DEVICES

DCV 601

Indoor Motion Viewer



- Passive Infrared Detector
- Integrated digital camera takes 10-second video clip when PIR is tripped
- Illuminators provide night vision up to 15 feet

DCV 651

Outdoor Motion Viewer



- Adds outdoor capability to DCV 601
- Extended Temperature (-20—140° F)
- IP-67 weatherproof enclosure
- Illuminators provide night vision up to 30 feet

CT 601

Door / Window Contact



- Detects opening of doors, windows and drawers
- Input accepts dry contacts from other devices

SD 601

Smoke Detector



- Adds smoke detection capability to Videofied system
- Wirelessly integrated

OUTPUT DEVICES & MOUNTING KIT

SE 601

Indoor Siren



- Additional burglary deterrent
- 115 dB alarm
- Wireless communication allows for mounting flexibility

SE 651

Outdoor Siren



- Adds outdoor capability to SE 601
- Extended Temperature (-20—140° F)
- Flashing strobe allows for easy site identification

MB 601

DCV 651 Mounting Bracket



- Attaches to DCV 651 Outdoor Motion Viewer
- Tilt, Turn and rotation capabilities
- **Magnetic Base (PAN 864) also available as an add-on to MB 601**

AVAILABLE ADD-ONS

NB141207

NEMA Box Enclosure



- Enclosure to waterproof V6000 ET for outdoor installations
- Plastic construction does not compromise RF signal
- 14"x12"x7" 4X NEMA Enclosure w/ plastic panel mount

YAGI Antenna Kit

GSM Cellular Antenna



- External antenna hardwires to V6000 series panel to improve cell reception
- Increases signal with 14 db gain
- Passive (no power required)
- Ideal for areas with minimal cellular reception

YAGI Antenna Kit Includes:

HG914Y-NF (Antenna)

CA-MMNFBCN19 (Pigtail)

CA-3N0XX

(coax cable length varies by application)

RF Antenna Kit

Omni-Directional RF Antenna



- External antenna hardwires to V6000 series panel to improve RF communication
- Increases signal with 9 db gain
- Passive (no power required)
- Ideal for enabling RF connections between obstacles

RF Antenna Kit Includes:

HGV-906U (Antenna)

CA-MMNFBCN19 (Pigtail)

RB1099254 (Modified Radio Board)

CA-3N0XX

(coax cable length varies by application)